

MONUMENT RECORD
State of Indiana - County of Monroe

Section: 17

Township: 8 North

Range: 1 East

Corner ID: Sa Cr E-09

Monument Description & Remarks: Found Sandstone with "+" (reported by Jess Gwinn, R.L.S.) at NW corner of section. Stone measured 0.65' (h) x 0.48' (l) x 0.19' (w). Line trees painted by State Forestry and "Archer" cap on property corner to the east (300' +/-).

References on file in the County Surveyor's Office: Legal Survey Book No. 2, Page 492.

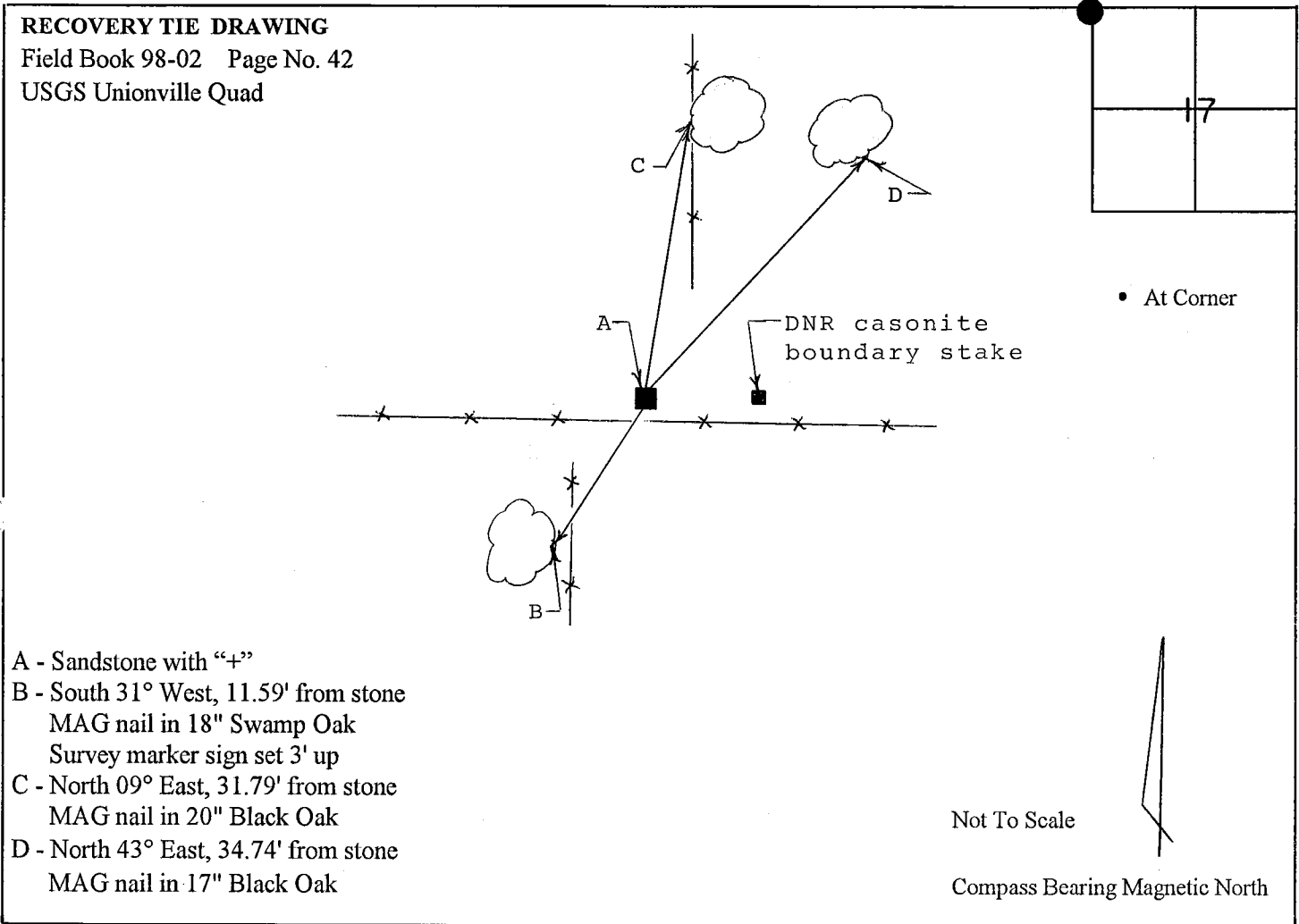

I, Kevin P. Enright, Monroe County Surveyor, hereby certify that this document was prepared under my direction in accordance with the provisions of Section 36-2-12-11 of the Indiana Code; and the above data is given under my hand and seal this 2nd day of December, 1998.

Kevin P. Enright

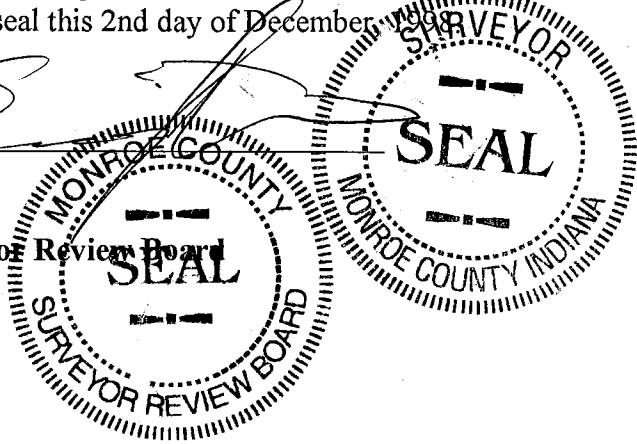

Administered by Surveyor Review Board